

## NEO 5

VERTICAL GRINDING CENTERS: COMPACT DESIGN

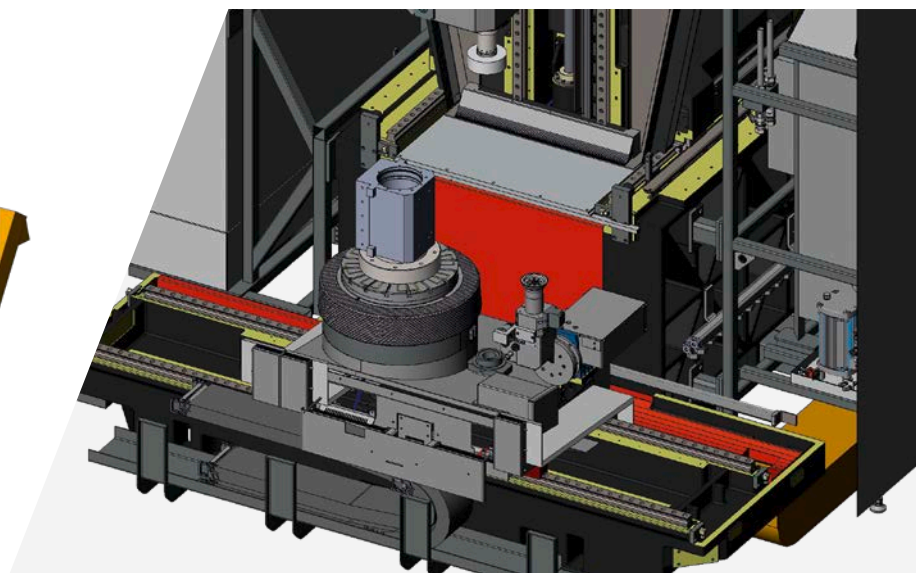
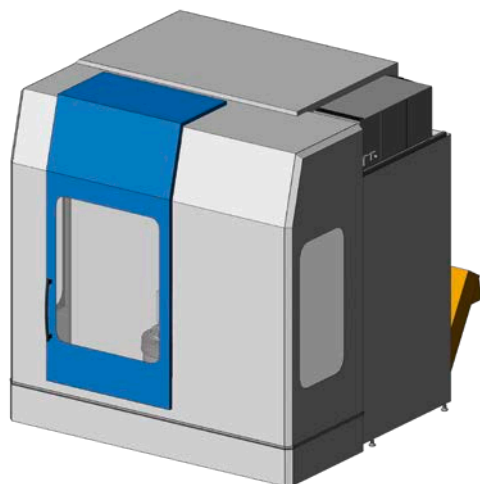

NUMBER OF SPINDLES: 1  
MAX. GRINDING DIAMETER: 600 MM

## 5-SIDE MACHINING IN ONE SETTING

- ✔ Wide range of applications
- ✔ Rigid casting design
- ✔ Hydrostatic guide way in the C-axis
- ✔ Linear guidance in the X-and Y-axis (if selected)
- ✔ Outstanding long-term precision and longevity

HIGHEST PRECISION AND COST-EFFECTIVENESS

## HIGHLIGHTS NEO 5

- ✔ Ergonomic and easy to operate
  - ✔ Compact and space saving design
  - ✔ Table diameter 500 mm
  - ✔ Work piece weight up to 1000 kgs
  - ✔ Rotary table design
  - ✔ Excellent machine rigidity and damping properties
  - ✔ Tool changing system underneath the column
- ✔ The following operations can be machined in only one set-up:
    - All machining applications of the Ri grinding centers
    - Fine milling and fine turning application, as well as 3-axis jig-machining
    - Flat grinding in oscillating movement
    - Machining of special materials
- Optional Y-axis
  - This additional axis enables to extend the machining performance to 5-side machining and to center the machine for e.g. grinding of Hirth- and Curvic-Couplings

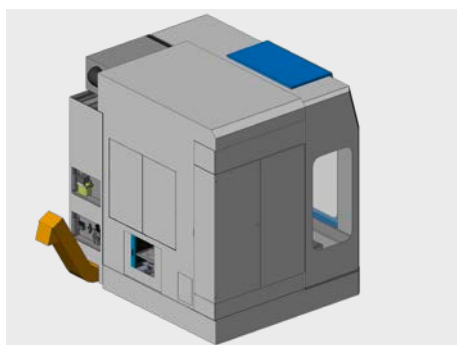

KEHREN NEO 5 (with housing)

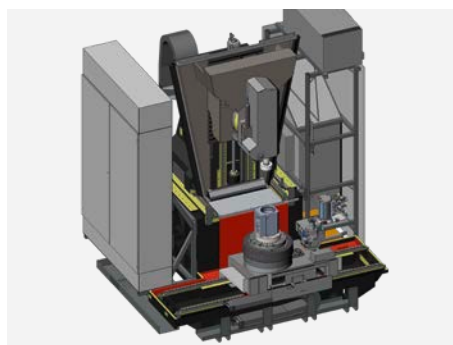

Front view (without housing)

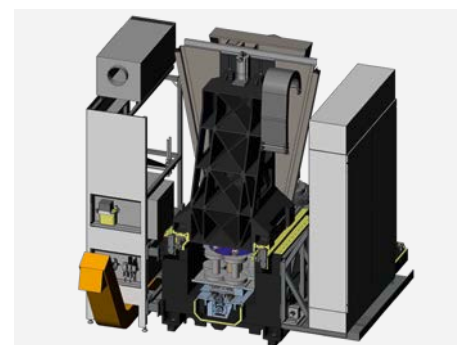

Rear view tool loading (without housing)

PRODUCT LINE	NEO
MODEL	NEO 5
Number of spindles	1
Table diameter [mm]	500
Grinding diameter [mm]	600
Table load [kg]	1000
Machine weight [kg]	12000
Nominal current [A]	90
Connection power [KVA]	60
Working area [mm]	D: 600 H: 400
Exterior dimension [mm]	X: 3500 Y: 2980 Z: 3650

**GET IN TOUCH WITH US TODAY**  
**TOGETHER WE WILL FIND A SOLUTION**  
**FOR YOUR REQUIREMENTS**

**KEHREN GMBH**

Phone: +49 2242 9197 0

info@kehren.com

www.kehren.com